



HOTENDS.COM

J-Head™ All-Metal HiFlow™

Product Description

The J-Head™ hotends have been a favorite among professionals and enthusiasts alike since 2011. With its innovative designs and low part count, there are few if any points of failure in a Genuine J-Head™ hotend. With a vertical heater cartridge, J-Head™ HiFlow™ hotends are faster than ever. With the all new J-Head™ All-Metal HiFlow™ we've focused on bringing down the overall cost, without sacrificing the quality we are known for at hotends.com.

So, if you want the best upgrade for your printer, you need Hotends.com J-Head™ All-Metal HiFlow™.

Hotends.com J-Head™ All-Metal HiFlow™

Improvements

- All-Metal construction giving you access to printing in PLA to extreme high temperature PEEK materials!
- New Universal top sporting our new Aglet™ fittings for bowden setups.
- Extended melt zone to reduce the temperature required for extrusion.
- Removed PEEK and PTFE materials from the hotend - The hotend is no longer temperature limited by PEEK.

Advantages

- Leak-less Design - Internally, the filament path is seamless top to bottom, unlike other hotend designs that provide multiple routes for melted filament to evacuate the hotend rather than through the nozzle itself.
- The design takes into account the thermal properties of the materials used to produce the best results.
- Extending from the mounting groove to the nozzle tip, the new J-Head™ All-Metal HiFlow™ hotend with its vertical heater cartridge is similar in length to our competitors - brackets, mounts and shrouds found on Thingiverse should work without modification!
- **All Metal Construction - NO PTFE liner** - This reduces a point of failure that is part of other hotend designs.
- Universal top featuring our new Aglet™ bowden fittings for zero backlash bowden tubes!
- Adjustable length for calibrating dual extrusion setups.
- Standard nozzles.

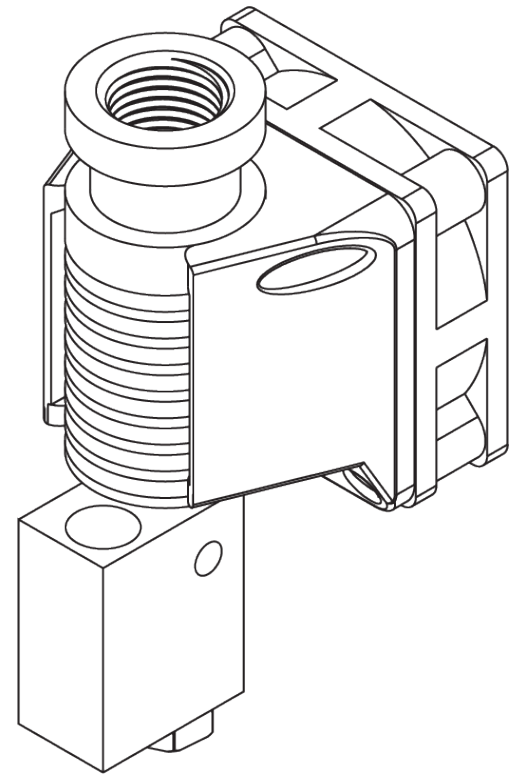

Dimensions:

Universal Top m10x1 threads
Body Diameter 16mm
Mounting Groove to Nozzle Tip (L) 54mm*
*Adjustable +/- 1mm

Whats Included:

- J-Head™ Temp Probe
- 12v/24v 40watt Heater Cartridge
- Fan with Shroud
- Nozzle
- Allen wrench

Installation Instructions:

- Insert the M3 stud thermistor into the threaded hole on the side of the heater block.
- Mount to the carriage with the mounting groove.
 - ◆ For bowden setups see Aglet™ installation instructions
- Plug in heater cartridge and thermistor and enjoy!